

# 16 Frame and Bodywork

## Table of Contents

Exploded View - Frame . . . . .	16.2
Exploded View - Seat Rails . . . . .	16.3
Exploded View - Cockpit and Mountings . . . . .	16.4
Exploded View - Lower Fairings . . . . .	16.5
Exploded View - Rear Panels . . . . .	16.6
Exploded View - Footrests and Mountings . . . . .	16.7
Seat . . . . .	16.8
Removal . . . . .	16.8
Refit . . . . .	16.8
Frame, Footrests and Fixings . . . . .	16.8
Inspection . . . . .	16.8
Rear Panel . . . . .	16.9
Removal . . . . .	16.9
Installation . . . . .	16.9
Left and Right Facia / Cockpit Infill Panels . . . . .	16.9
Removal . . . . .	16.9
Installation . . . . .	16.10
Fuse Box / Stowage Box . . . . .	16.10
Removal . . . . .	16.10
Installation . . . . .	16.11
Lower Fairing . . . . .	16.11
Removal . . . . .	16.11
Installation . . . . .	16.12
Windscreen and Under-Screen Trim . . . . .	16.12
Removal . . . . .	16.12
Installation . . . . .	16.12
Cockpit . . . . .	16.13
Removal . . . . .	16.13
Installation . . . . .	16.13

# Frame and Bodywork

## Exploded View - Frame

All engine mouning fixings - see text in section 9

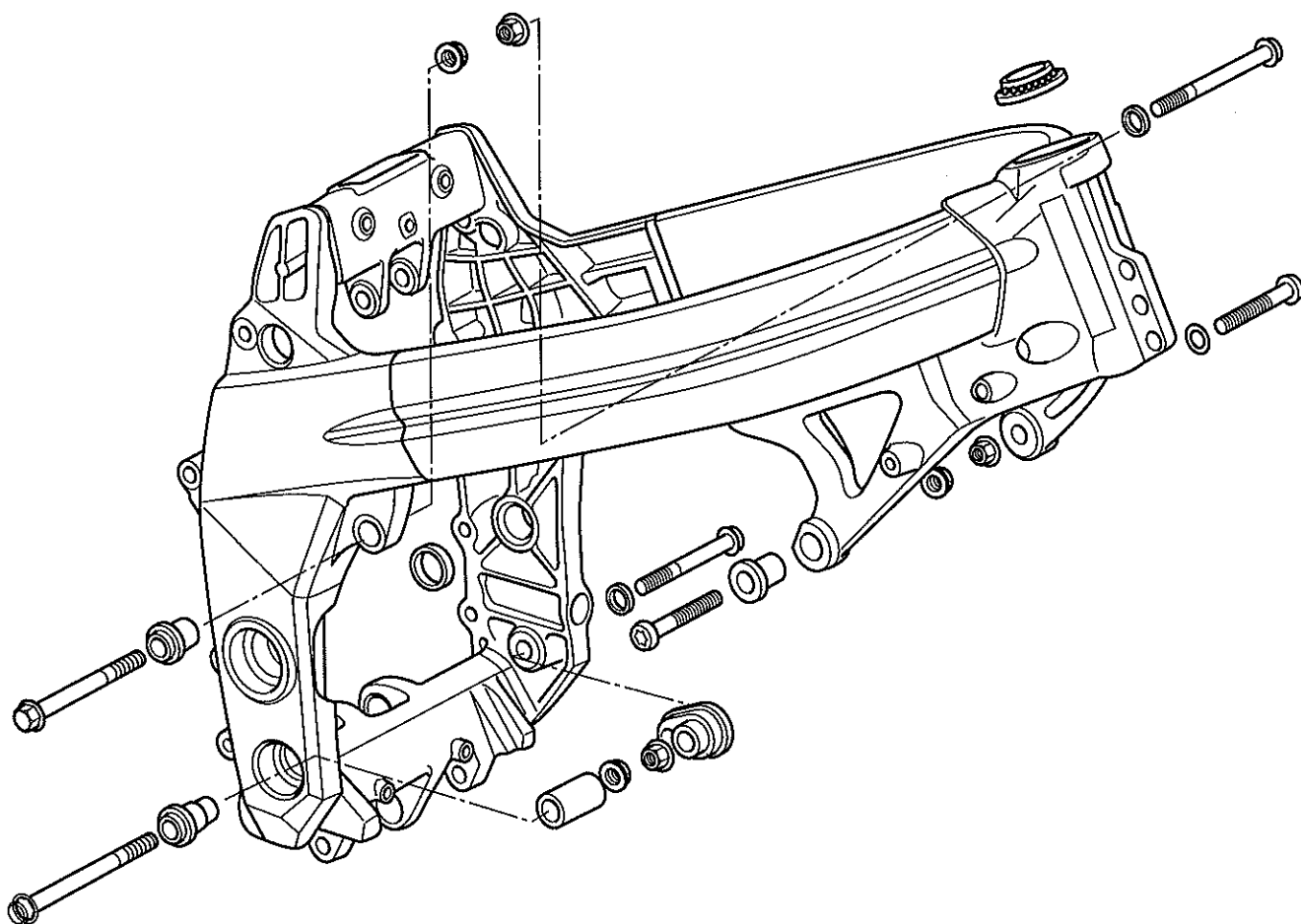

Exploded View - Seat Rails

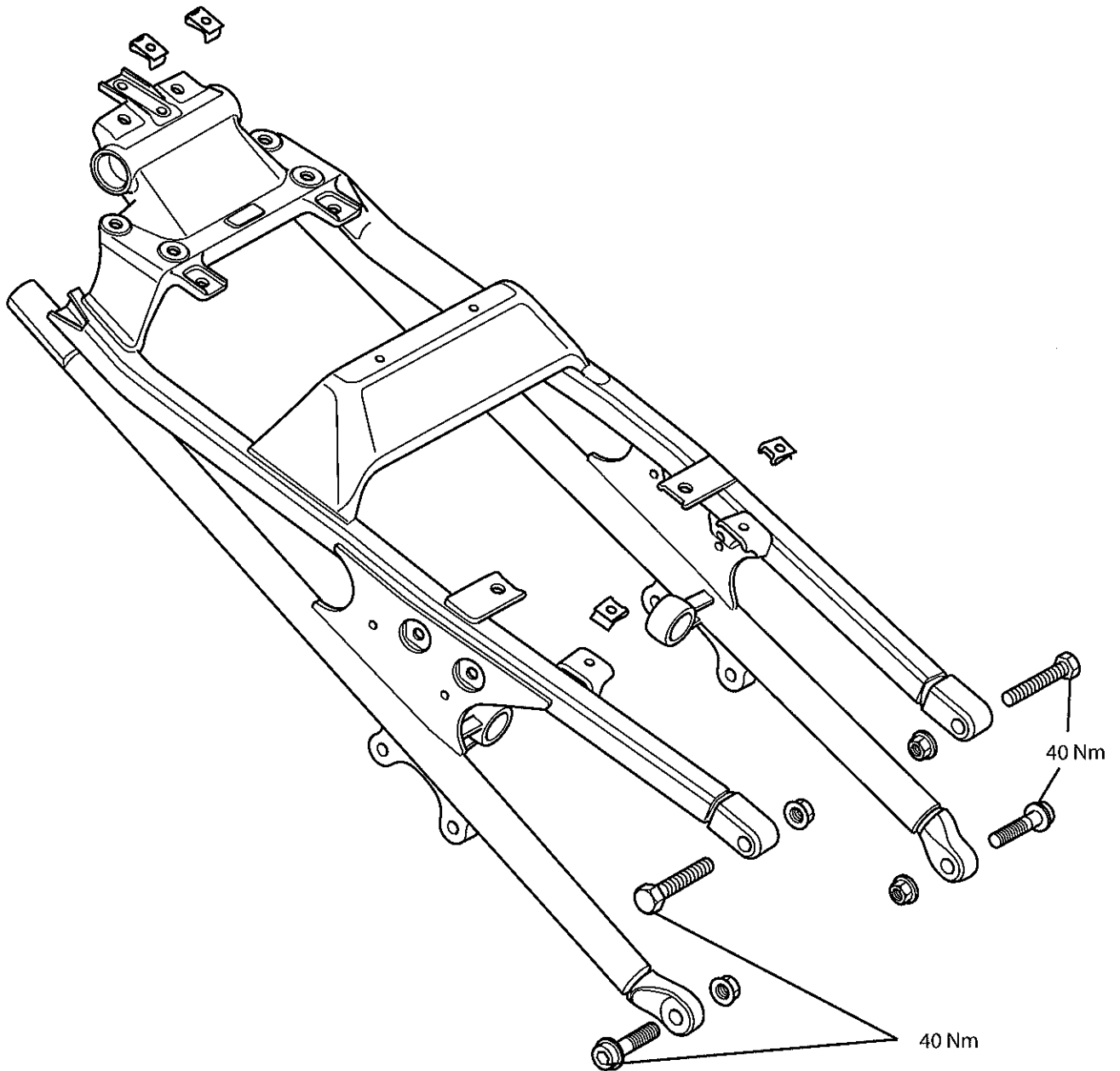

# Frame and Bodywork

## Exploded View - Cockpit and Mountings

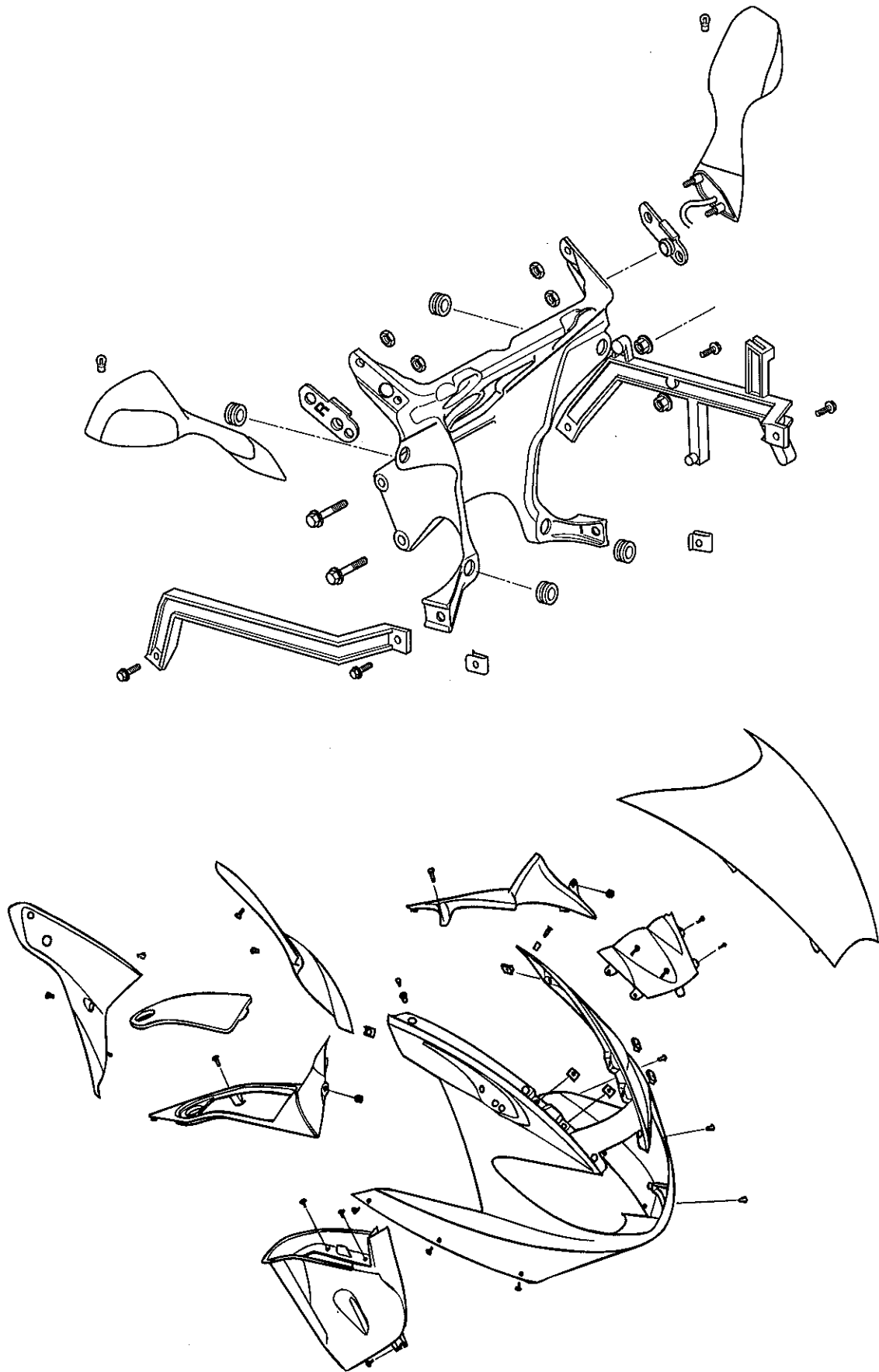

All fixings - see text

Exploded View - Lower Fairings

All fixings - see text

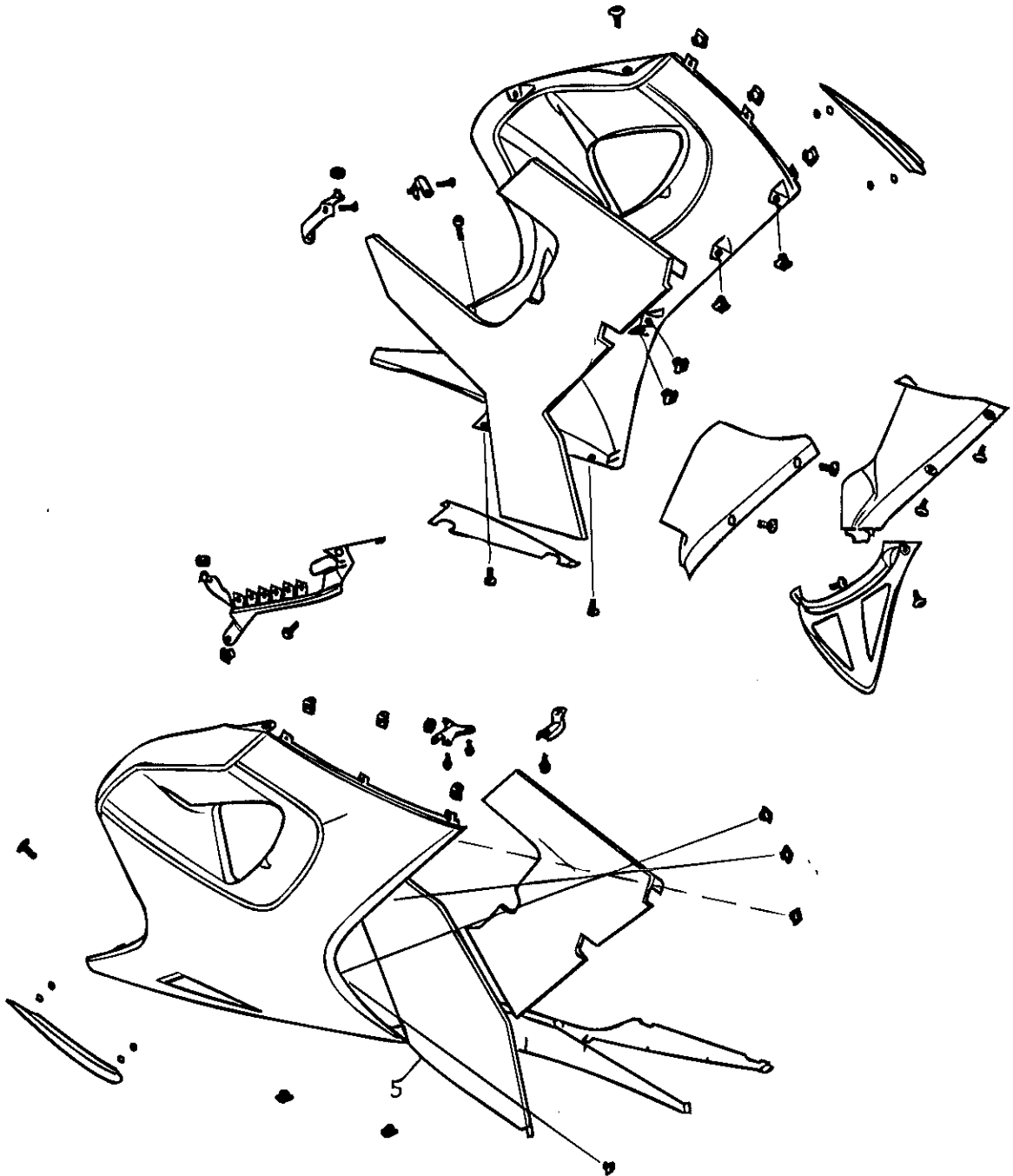

# Frame and Bodywork

## Exploded View - Rear Panels

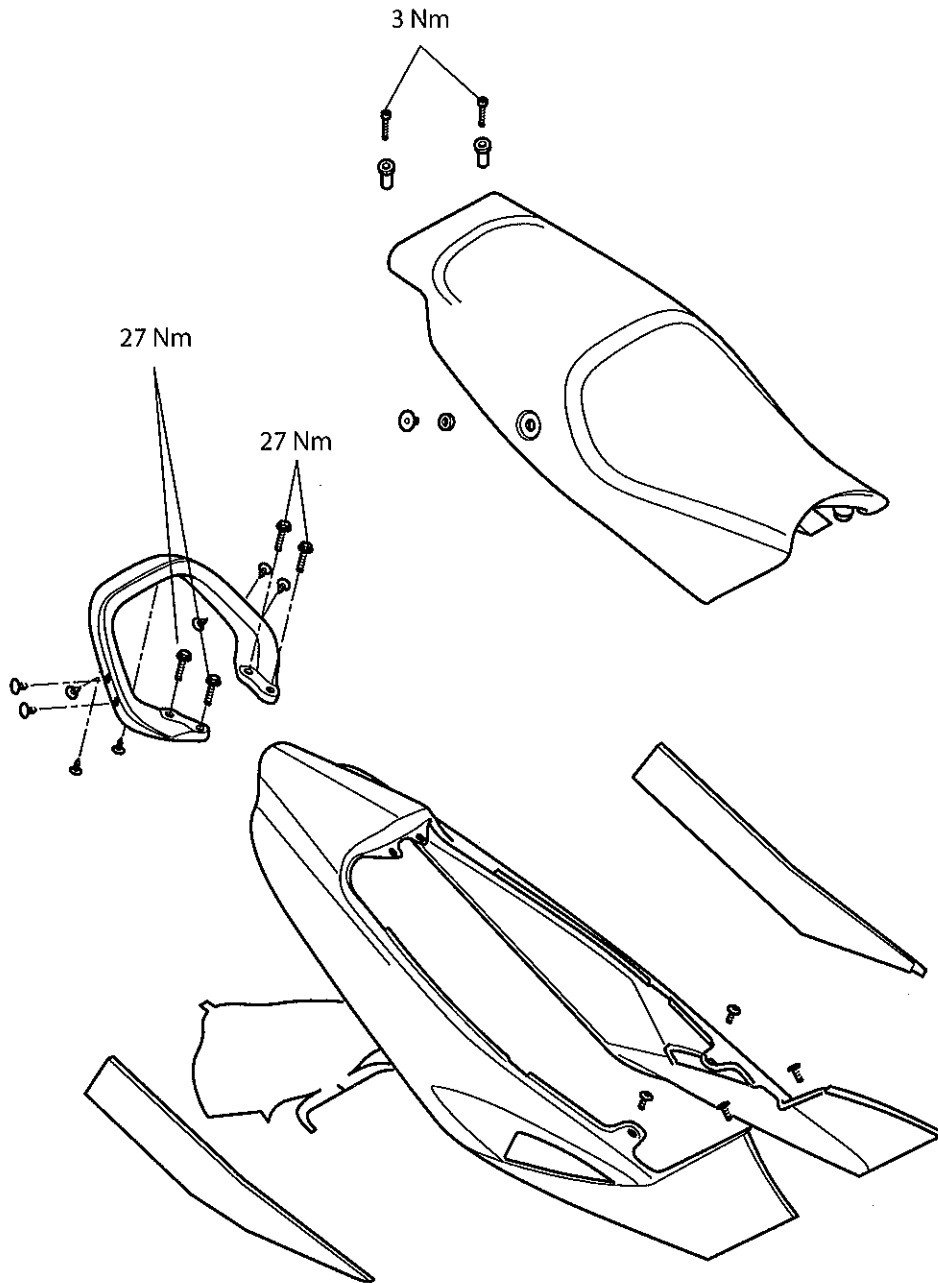

All body panel fixings - 3 Nm

Exploded View - Footrests and Mountings

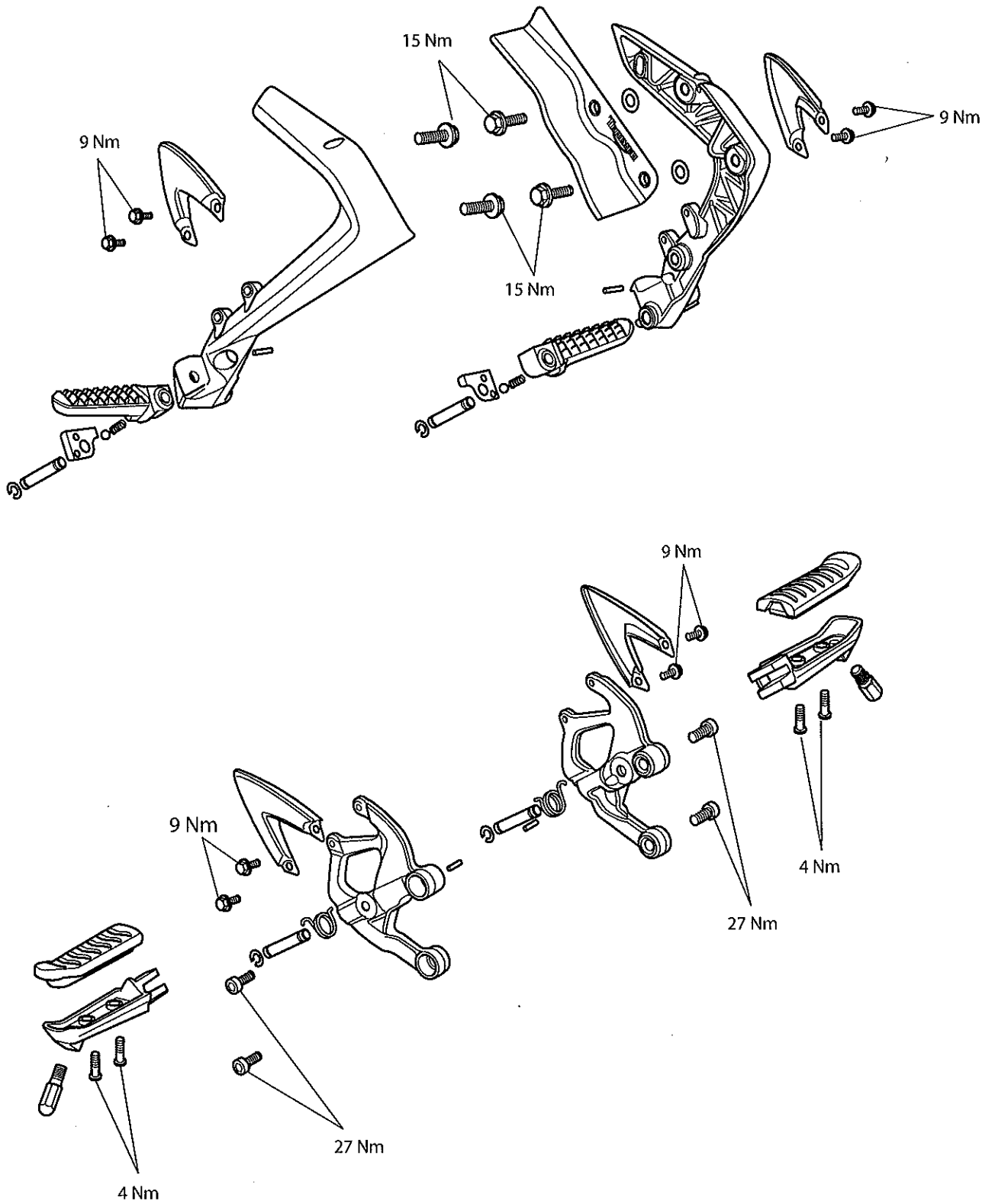

# Frame and Bodywork

## Seat

### Removal

The seat fasteners are located under the rear edge of the seat.

1. Push back the rear edge of the seat and unscrew the exposed fixings. Collect the spacers from beneath the fixings.

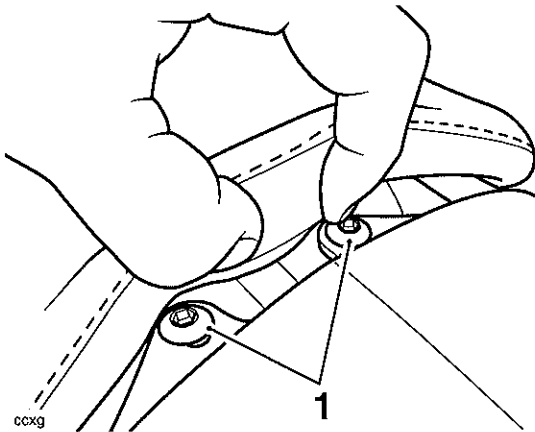

#### 1. Seat fasteners

2. To detach the seat, lift the rear of the seat and slide it rearwards.

### Refit

1. Position the seat to the fuel tank bridge and engage the front lip.
2. Press down on the rear of the seat to engage.
3. Push back the rear edge of the seat and secure the fixings. Tighten to **3 Nm**.
4. Grasp the seat and ensure that it is securely retained.

## Frame, Footrests and Fixings

### Inspection

1. Inspect the frame, footrests and fairings for damage, cracks, chafing and other dangerous conditions. Check fairing and frame fixings for security.
2. Inspect the bank angle indicators on the rider's footrests for wear. The bank angle indicators are worn out when 5mm of the bank indicator remains.

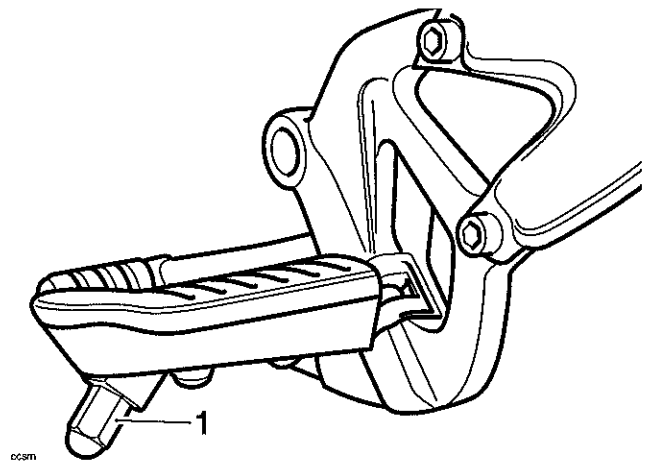

#### 1. Bank angle indicator

### Warning

Use of a motorcycle with bank angle indicators worn beyond the maximum limit will allow the motorcycle to be banked to an unsafe angle.

Banking to an unsafe angle may cause instability, loss of control and an accident causing injury or death.

### Warning

If the motorcycle is involved in an accident or collision it must be taken to an authorised Triumph dealer for repair or inspection.

Any accident can cause damage to the motorcycle which, if not correctly repaired, may cause another accident which may result in injury or death.



**Warning**

The frame must not be modified as any modification to the frame such as welding or drilling may weaken the frame resulting in an accident.

## Rear Panel

### Removal

1. Remove the seat (see page 16-8).
2. Disconnect the battery, negative (black) lead first.
3. Remove the grab rail.
4. To release the rear panel assembly, remove the fixings shown in the illustration below and collect the four washers on the two rearmost fixings.

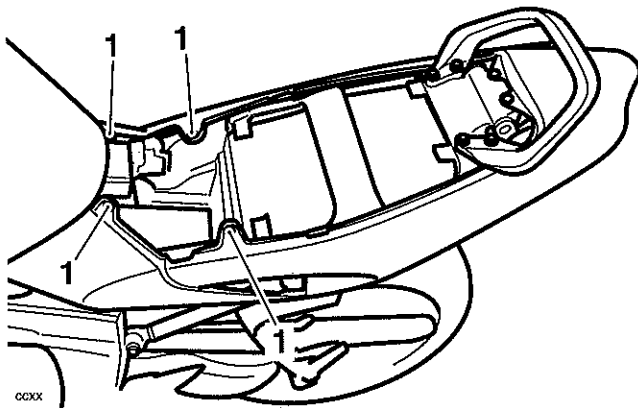

### 1. Rear Panel Fixings

5. Gently pull the panel outwards.
6. Withdraw the panel assembly from the rear of the motorcycle.

### Installation

1. Installation is the reverse of removal noting the following.

#### Note:

- The two rearmost fixings have a washer above and below the panel mountings.
- Tighten fixings to 3 Nm.
- Reconnect the battery, positive (red) lead first.

## Left and Right Facia / Cockpit Infill Panels

### Removal

#### Note:

- Follow the same procedure for both left and right hand sides.

1. Remove the seat (see page 16-8).
2. Disconnect the battery, negative (black) lead first.

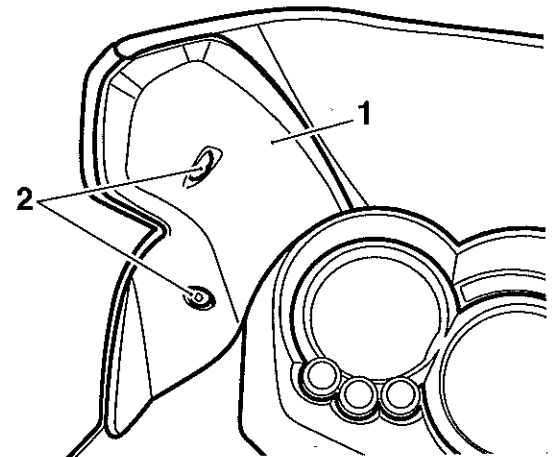

### 1. Facia infill panel

### 2. Fixings

3. Remove the two screws securing the upper facia infill panel. Note the length and position of the screws.
4. To remove the facia infill panel ease the top towards the motorcycle centre line. This will allow the lip under the instruments to be withdrawn. Pull to the rear to extract the bayonet from the grommet in the cockpit infill panel.
5. Remove the lid from the stowage compartment.

# Frame and Bodywork

6. Remove the screws securing the cockpit infill panel.

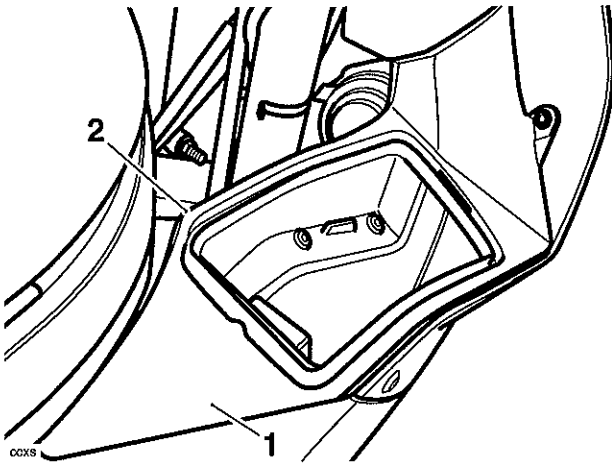

1. Cockpit infill panel
2. Fixings

7. The rear of the cockpit infill is located into the fairing with a hook. The panel must be moved forwards until the hook is clear of the slot.
8. Remove the panel.

## Installation

1. Installation is the reverse of removal noting the following.

### Note:

- Tighten fixings to 5 Nm.
- Reconnect the battery, positive (red) lead first.

## Fuse Box / Stowage Box

### Removal

1. Remove the right hand facia and cockpit infill panels (see page 16-9).
2. Remove the right hand lower fairing (see page 16-11).
3. Remove the contents of the stowage compartment.

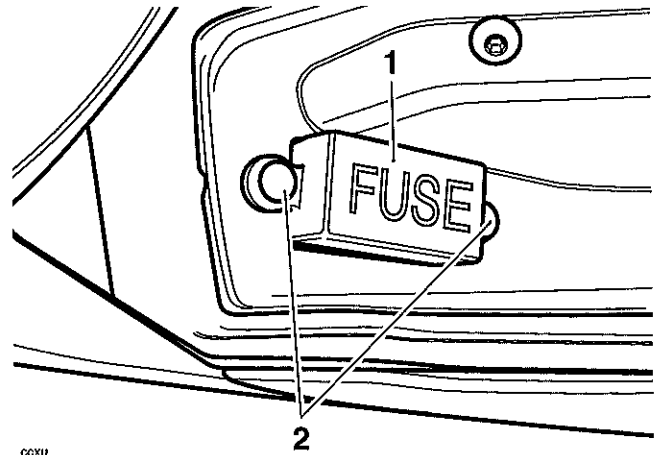

1. Fuse box
2. Fuse box fixings

4. Remove the fir tree fixings securing the fuse box to the stowage compartment. Detach the fuse box.
5. Remove the three screws securing the stowage box to the subframe.
6. Remove the stowage box.

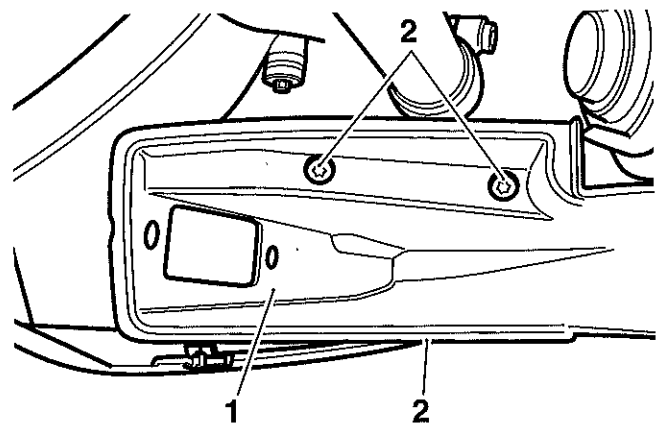

1. Stowage box
2. Stowage box fixing locations

## Installation

1. Installation is the reverse of removal noting the following.

### Note:

- Tighten the stowage box fixings to 6 Nm.
- Tighten the lower fairing fixings to 5 Nm.
- Reconnect the battery, positive (red) lead first.

## Lower Fairing

### Removal

#### Note:

- The cockpit does NOT need to be removed in order to remove the lower fairings.

1. Remove the seat (see page 16-8).
2. Disconnect the battery, negative (black) lead first.
3. Remove the facia and cockpit infill panels (see page 16-9).
4. Remove the two screws securing the fairing lower halves to each other.

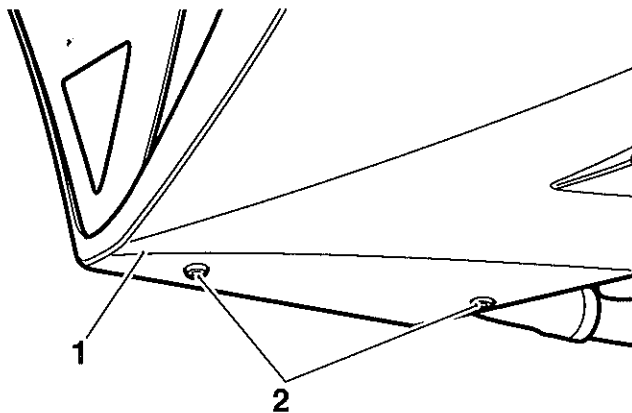

cchd

1. Lower Fairing
2. Fixings

5. Remove the two screws holding the oil cooler infill panel. Withdraw the panel in an upward direction.

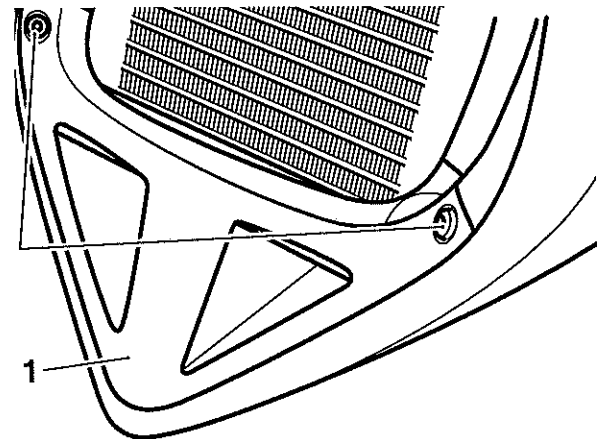

1. Oil cooler infill panel
2. Fixings

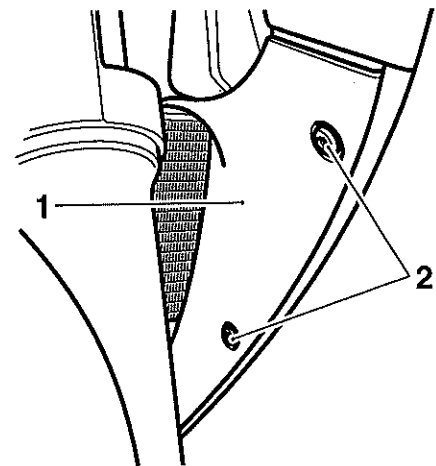

ccxv

1. Radiator infill panel (LH shown)
2. Fixings

6. Remove the two screws securing each of the radiator infill panels.
7. Remove the two screws securing each fairing to the fairing brackets.

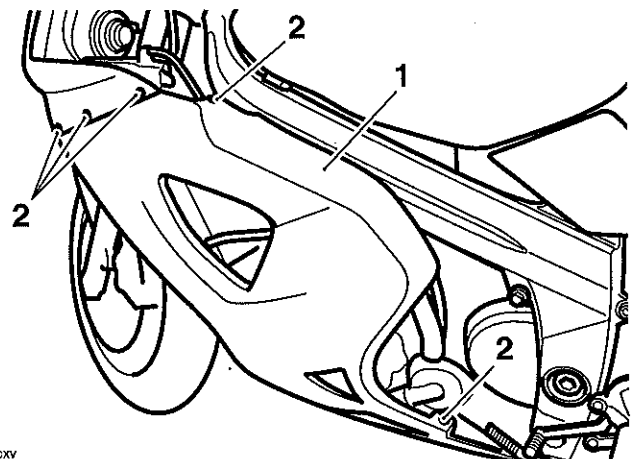

ccxv

1. Lower Fairing (RH shown)

# Frame and Bodywork

## 2. Fairing Retaining Screws

8. Remove the three screws securing each fairing to the cockpit.
9. Ease the panel away from the cockpit to remove it.

## Installation

1. Position each fairing to the rear of the upper mounting.
2. Refit the fairing to the cockpit, tighten the fixings to **5 Nm**.
3. Refit the fairings to the fairing brackets, tighten the fixings to **5 Nm**.
4. Refit the radiator infill panels, tighten the fixings to **6 Nm**.
5. Refit the oil cooler infill panel, tighten the fixings to **6 Nm**.
6. Refit the lower fairing fixings, tighten the fixings to **5 Nm**.
7. Refit the facia and cockpit infill panels (see page 16-11).
8. Reconnect the battery, positive (red) lead first.
9. Refit the seat (see page 16-8).

## Windscreen and Under-Screen Trim

### Removal

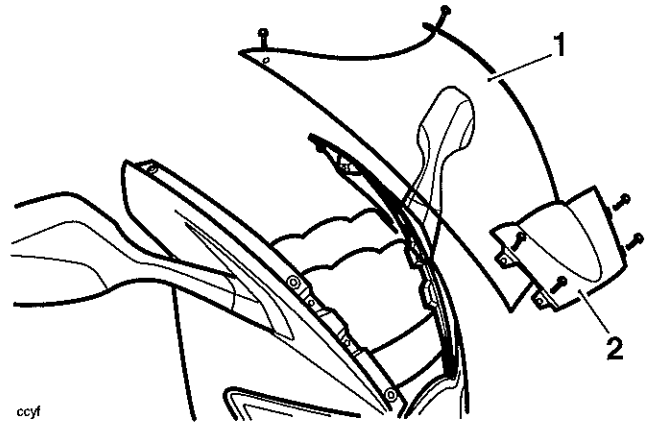

1. Windscreen
2. Under-screen trim

1. Release the windscreen upper fixings.
2. Slide the windscreen upwards and to the rear.
3. Release the fixings securing the under-screen trim and remove the trim.

### Installation

Installation is the reverse of removal noting the following.

#### Note:

- Tighten fixings to **5 Nm**.

## Cockpit

### Removal

#### Note:

- The cockpit is removed as an assembly. It is not necessary to remove the lower fairings, instruments or headlight unit.

- Remove the seat (see page 16-8)
- Disconnect the battery, negative (black) lead first.
- Remove the facia and cockpit infill panels (see page 16-9).
- Remove the windscreen and under-screen trim (see page 16-12).

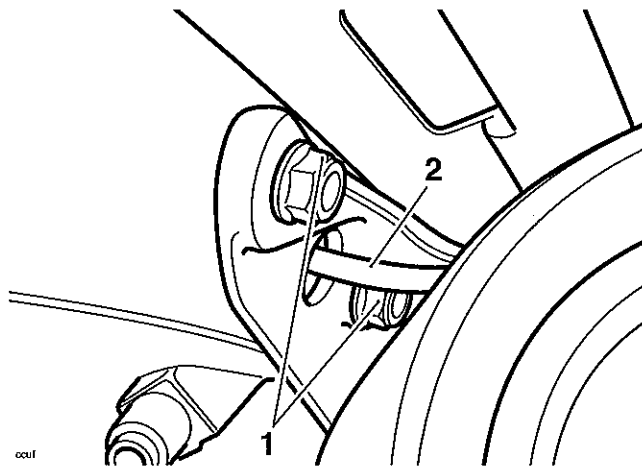

- Mirror fixings
- Indicator wires

- Release the two nuts on each mirror.
- Disconnect the direction indicators at their multiplugs in the area under the screen trim.

- Remove both mirrors.

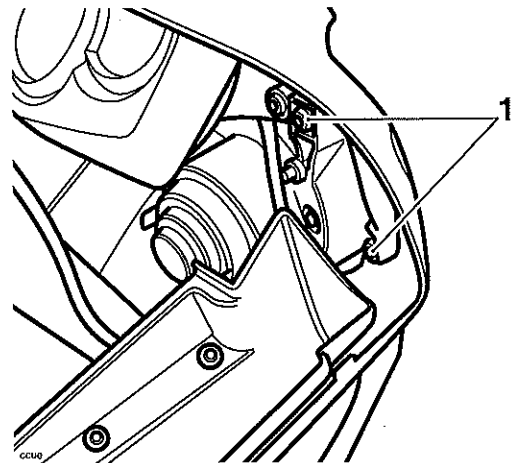

- Cockpit to headlight screws (right hand shown)
- Remove the four screws securing the cockpit to the headlight assembly

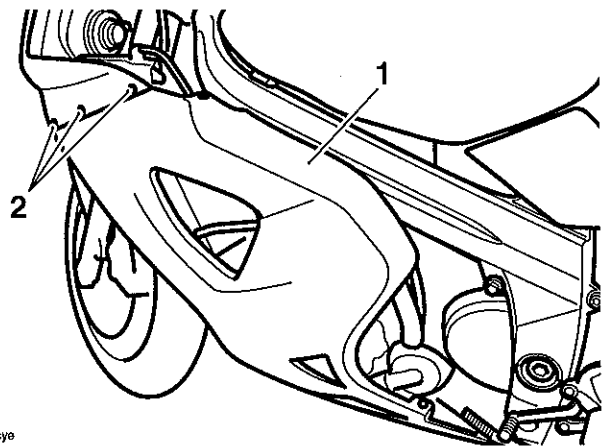

- Lower fairing
- Cockpit to lower fairing screws

- Remove the three screws securing the cockpit to each lower fairing.
- Remove the cockpit in a forward direction.

### Installation

- Position the cockpit to each lower fairing.
- Refit the cockpit to the fairings, tighten the fixings to **5 Nm**.
- Refit the fairing to the headlight assembly, tighten the fixings to **6 Nm**.
- Fit the mirrors, tighten the fixings to **9 Nm**.
- Refit the instruments (see page 17-17).
- Refit the windscreen and under-screen trim (see page 16-12).

## Frame and Bodywork

---

7. Refit the facia and cockpit infill panels (see page 16-11).
8. Connect the battery, positive (red) lead first.
9. Refit the seat (see page 16-8).